

THIS DRAWING CONTAINS INFORMATION PROPRIETARY TO RF INDUSTRIES,  
 ANY UNAUTHORIZED USE OF THIS DRAWING IS EXPRESSLY PROHIBITED  
 WITHOUT WRITTEN PERMISSION FROM RF INDUSTRIES.  
 ANY VIOLATION IS PUNISHABLE UNDER U.S. COPYRIGHT LAWS.

ALL DIMENSIONS ARE REFERENCE ONLY

PART NO.

**RFU-507-SI**

REV	DESCRIPTION	DWN	DATE	APPROVED
N	CHANGE CONTACT ITEM #2 & DIELECTRIC ITEM #3	CZS	2/17/98	R. RICE
P	ADD DIM TO CONTACT / REMOVE P/N	CZS	8/3/99	R. RICE
R	CHG. FERRULE STUD, STRIPPING INSTRUCTIONS & DWG #8049	GGG	2/18/02	JDMc
S	UPDATED CABLE GROUP LIST	CZS	08/08/06	JDMc

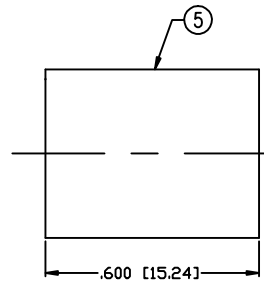
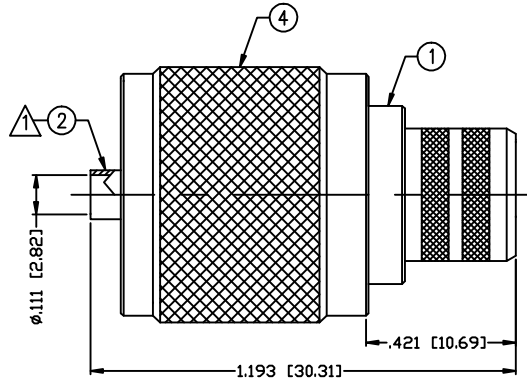

RECOMMENDED CRIMP DIE: .429'

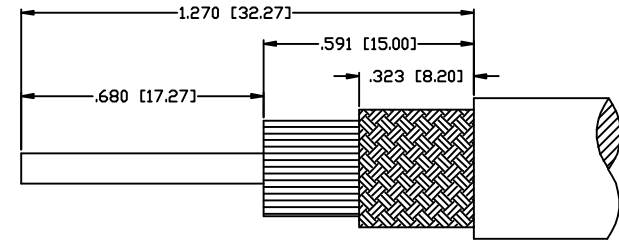

RECOMMENDED STRIPPING INSTRUCTIONS

**SPECIFICATIONS:**

IMPEDANCE: NON CONSTANT  
 FREQUENCY RANGE: 0-300 MHz  
 WORKING VOLTAGE: 500 V rms max. @ sea level  
 FOR BELDEN 8214, 9913, 9913F, 9914, RG-8/U TYPE,  
 CAROL C1180, TIMES AA-5886 & LMR-400 CABLE

RECOMMENDED CRIMP DIE: .118" or .128"  
 \*SOLDER ONLY\* FOR RG-8/U TYPE & 'E' CABLE GROUP

1	BODY	1	BRASS	SILVER, 30μ"
2	CONTACT	1	BRASS	SILVER, 80μ"
3	DIELECTRIC	1	PTFE	---
4	SHELL	1	BRASS	SILVER, 30μ"
5	FERRULE	1	BRASS	SILVER, 30μ"
6				
7				
8				
9				
10				
11				
12				
13				
14				

000468	
DRAWN	08/08/06
C. ZUNIGA	
CHECKED	
ORJ DRAWN	4/2/92
C. JONES	

UNLESS OTHERWISE SPECIFIED:  
 1. REMOVE ALL BURRS  
 2. BREAK ALL CORNERS & EDGES .005 R. MAX.  
 3. CHAMFER 1ST & LAST THREADS 45°  
 4. SURFACE ROUGHNESS 63 FINISH MIL-STD-10  
 5. DIAMETERS ON COMMON CENTERS TO BE CONCENTRIC WITHIN .002 T.I.R.  
 6. ALL DIMENSIONS ARE AFTER PLATING.

DIMENSIONS ARE IN INCHES AND [MILLIMETERS]  
 UNLESS OTHERWISE NOTED TOLERANCES ARE:

DECIMALS	DIAMETER
.xxx±.003 [.08]	.xxx±.001 [.03]
.xx±.005 [.13]	.xx±.003 [.08]

RF

7610 MIRAMAR RD  
 SAN DIEGO, CA 92126  
 (858) 549-6340  
 (858) 549-6345 FAX

DIVISION OF RF INDUSTRIES, LTD.

## UHF PLUG, CRIMP

SIZE	CABLE GROUP	DWG NO.	REV
A	I	RFU-507-SI	S

SCALE: NTS	CAD FILE OUTLINE	SHEET 1 OF 1
------------	------------------	--------------