

REVISIONS				
REV.	DESCRIPTION	ECN	DATE	APPROVED
J	REFER TO ECN	12061	9/26/13	KCB

**HARDWARE KIT INCLUDES:**

QTY	DESCRIPTION
1	O-RING 114 EPDM
1	WASHER 5/8 410 SS
1	NUT 5/8-24 303 HEX SS
2	WASHER 10 INT 4-10 SS
1	NUT 10-32 HEX 18-8 SS
1	SCREW 10-32x.75 HEX MS 18-8 SS

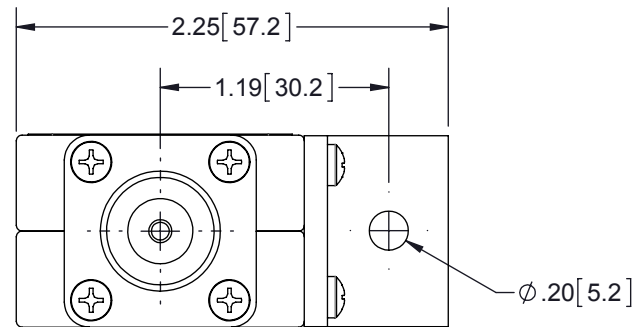
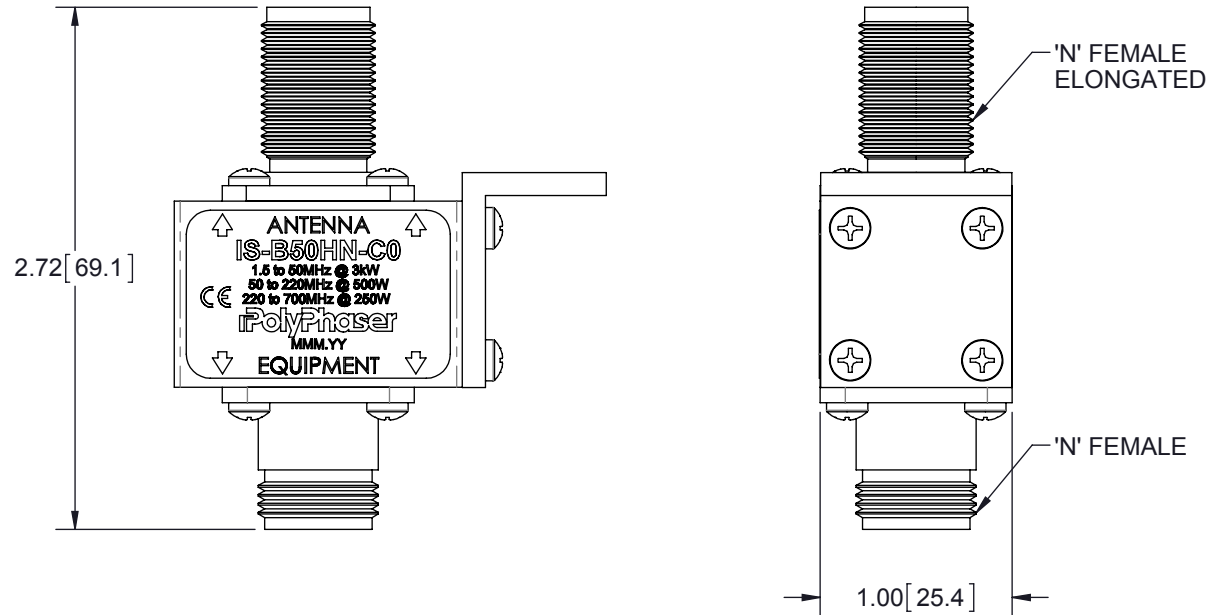

**MAXIMUM CHARACTERISTICS**

**APPLICATION:**

TWO WAY RADIO AND SCADA APPLICATIONS  
NON-WEATHERIZED, BULKHEAD MOUNT

**FREQUENCY RANGE:**

1.5MHz TO 700MHz

**SURGE:**

50kA IEC 61000-4-5 8/20ms WAVEFORM (TESTED)  
20kA (RATED)

**TURN-ON:**

1,200Vdc ±20% 7ns FOR 2kV/ns

**VSWR:**

≤1.1:1 @ 1.5MHz TO 700MHz

**INSERTION LOSS:**

≤ 0.1dB OVER FREQUENCY RANGE

**MAX POWER:**

3kW @ 1.5MHz TO 50MHz  
500W @ 50MHz TO 220MHz  
250W @ 220MHz TO 700MHz

**THROUGHPUT ENERGY:**

≤20µJ TYPICAL

**TEMPERATURE:**

STORAGE: -55°C TO +85°C  
OPERATING: -50°C TO +50°C

**RELATIVE HUMIDITY:**

90% @ 40°C

**VIBRATION:**

1G AT 5Hz TO 100Hz

**CE COMPLIANT**

**RoHS COMPLIANT**

CUSTOMER APPROVAL: \_\_\_\_\_ DATE: \_\_\_\_\_

ALL DIMENSIONS SHOWN ARE FOR REFERENCE ONLY.

UNLESS OTHERWISE SPECIFIED LEADING DIMENSIONS ARE INCHES DIMENSIONS IN [ ] ARE MILLIMETERS	DRAWN <b>M. WALSER</b>	DATE 6/2/95	<b>PolyPhaser</b>	SHEET 1	OF 1
	ENG APPD <b>J. JONES</b>	6/2/95		SCALE 1:1	
TOLERANCES: FRACTIONS=± 1/32 .XX=± .03 ANGLES=± 1° .XXX=± .010	PRODUCT MGR		TITLE <b>BROADBAND 1.5-700MHz R50 T.O. 1200Vdc N FEM BLKH</b>	CUSTOMER SPECIFICATION	
NOTICE: THE INFORMATION AND DESIGN IN THIS DOCUMENT IS THE PROPERTY OF POLYPHASER CORPORATION. ALL RIGHTS RESERVED.	MARKETING APPD <b>R. MATHEUS</b>	6/2/95		PROJECT NO.	DOCUMENT NAME <b>IS-B50HN-C0-C</b>
THIRD-ANGLE PROJECTION 			PROD CAT <b>RFP</b>	PART NUMBER <b>IS-B50HN-C0</b>	REV <b>J</b>

THESE COMMODITIES, TECHNOLOGY OR SOFTWARE WERE EXPORTED FROM THE UNITED STATES IN ACCORDANCE WITH THE EXPORT ADMINISTRATION REGULATIONS. DIVERSION CONTRARY TO U.S. LAW PROHIBITED.